



# CAREY CIRCLES



Residents of Carey

Developer : Amverton Prop Sdn Bhd (117812-W)  
( a wholly owned subsidiary of HIL Industries Berhad )

Show Units : Jalan Andika 1, Laman Amverton,  
42960 Pulau Carey, Kuala Langat, Selangor.  
[www.amvertonprop.hil.com.my](http://www.amvertonprop.hil.com.my)

6010 - 828 8836

# The Ideal Location

Carey Circles @ Eco-Village is ideally located on the tranquil, lush green Carey Island.

Easily accessible via major highways, it is just 25 minutes away from Putrajaya, Cyberjaya and KLIA.

CAREY CIRCLES  
Residents of Carey





# The Overall Master Plan



- |   |                          |   |             |
|---|--------------------------|---|-------------|
| 1 | Guard House              | 5 | Water Edge  |
| 2 | Pavilion / Clubhouse     | 6 | Villas      |
| 3 | Tennis in The Forest     | 7 | Utilities   |
| 4 | Manucured Pocket Gardens | 8 | Streetscape |

Open space has never before been such a luxury.  
Especially since many of us have been cooped up in our homes during the necessary lockdowns implemented to battle the Covid-19 pandemic.





# Open Spacious Living

Carey Circles @ Eco-Village offers an environment where you and your family can be safe and socially distanced while having enough open space to feel comfortable and free.

Get a breath of fresh air while taking a leisurely walk along manicured gardens. Stretch out and enjoy the outdoors in safe and lush green surroundings.

Resort styled bungalows await you in a well spaced, gated development that has all the facilities and requirements for a healthy family lifestyle.



## Convenience At Your Doorstep



The convenience of numerous family entertainment facilities nearby provides great opportunities for quality family time. A world-class golf course, a water theme park, ATV rides and a fully functional clubhouse will provide ample activity that promotes togetherness and family bonding.

Resort-like facilities at the clubhouse includes a large swimming pool, gymnasium, mini theater, function rooms, restaurant, tennis courts, karaoke room among others that will provide hours of family fun in a safe and protected environment.





# The Clubhouse



Carey Circles @ Eco-Village has everything right at your doorstep. While offering a private living area that is spacious yet sufficiently distanced, it is also very near to a host of amenities that include restaurants, convenience shops & grocers, spas & beauty centres among others.





## 24Hour Concierge Services

Residents of Carey Circles can have exclusive access to a range of selected services provided by Scarisbrick International, a professional concierge services provider for a modest monthly fee. These services would include:

- **Private Butler Service**

Have a private butler on call 24/7 to assist with anything from newspaper delivery to shoe polishing to managing family events.

- **Professional Concierge Services**

There to assist with your travel arrangements that would include flight bookings, hotel rooms, theater tickets etc.

- **Housekeeping & Cleaning Services**

Professional housekeepers and cleaners will have your home spick and span while you relax and indulge in your favourite pass time.

- **Laundry Service**

Have your sheets laundered on a weekly basis and all your other laundry and dry-cleaning needs taken care of without hassle and right to your doorstep.



- **Nurse / Caregiver Services**

To ensure your wellbeing and safety, there are a range of services that include in-residence care/nursing, paramedic check-ups, basic first aid and even full time care from 1 hour to 24/7.

- **Wellness Programmes**

The wellness programmes are healthy, fun and a great way to socialize. Offering classes and activities such as yoga, dance, aerobics, gardening classes, cooking classes and even special interest evenings.

- **Pet Services**

Taking care of pets can be hard work. Let us take care of your pets with such services as dog-walking, grooming and veterinarian care.

- **Healthcare Services**

Assisting you with a host of medical services such as doctor's visits, dental visits, optometrist visits and chiropractor visits, where we take you from your doorstep and send you back home safely after your visit.

You can also get your medicines and supplements delivered right to you from your chosen pharmacy.

\*Additional 'pay per use' fees may apply.





# Ko Samui

Structure : Reinforced Concrete

Roof : Reinforced Concrete Flat Roof /  
Stone-coated Steel Metal Roof

Wall : Masonry

Ceiling Finishes : Skim Coat / Plaster Ceiling

Wall Finishes : Internal Paint - Emulsion Paint  
External Paint - Exterior Weather-resistant Paint  
Kitchen - Porcelain Tiles  
Master Bathroom - Porcelain Tiles  
/ Other Bathrooms

\* No finishes will be provided at the back of the fixtures such as mirror, kitchen cabinets and etc (where applicable)

Floor Finishes : Living / Dining / - Porcelain Tiles  
Kitchen / Terrace /  
Utility / Master  
Bathroom /  
Bathrooms  
: Master Bedroom /  
Other Bedrooms - Timber Flooring  
: Car Porch /  
Driveway - Interlocking Paver  
: Aircon  
Compressor Area - Cement Rendering

Door : Entrance - Timber Door  
Bedrooms /  
Bathrooms /  
Utility  
Dining - Aluminium Frame Sliding Door  
Aircon  
Compressor Area - Aluminium Screen Door

Windows : Aluminium Frame Window



## Homes To Suit Your Family

Each home is designed to offer a resort styled living concept, with its own private swimming pool. Your home will be like a luxury resort villa where you and your family can enjoy a comfortable lifestyle even during the strictest of lockdowns.





# Bali

Structure : Reinforced Concrete

Roof : Reinforced Concrete Flat Roof /  
Stone-coated Steel Metal Roof

Wall : Masonry

Ceiling Finishes : Skim Coat / Plaster Ceiling

Wall Finishes : Internal Paint - Emulsion Paint  
External Paint - Exterior Weather-resistant Paint  
Kitchen - Porcelain Tiles  
Master Bathroom - Porcelain Tiles  
/ Other Bathrooms

\* No finishes will be provided at the back of the fixtures such as mirror, kitchen cabinets and etc (where applicable)

Floor Finishes : Living / Dining / - Porcelain Tiles  
Kitchen / Terrace /  
Utility / Master  
Bathroom /  
Bathrooms  
: Master Bedroom /  
Other Bedrooms - Timber Flooring  
: Car Porch /  
Driveway - Interlocking Paver  
: Aircon  
Compressor Area - Cement Rendering

Door : Entrance - Timber Door  
Bedrooms /  
Bathrooms /  
Utility  
Living / Dining - Aluminium Frame Sliding Door  
Aircon  
Compressor Area - Aluminium Screen Door

Windows : Aluminium Frame Window

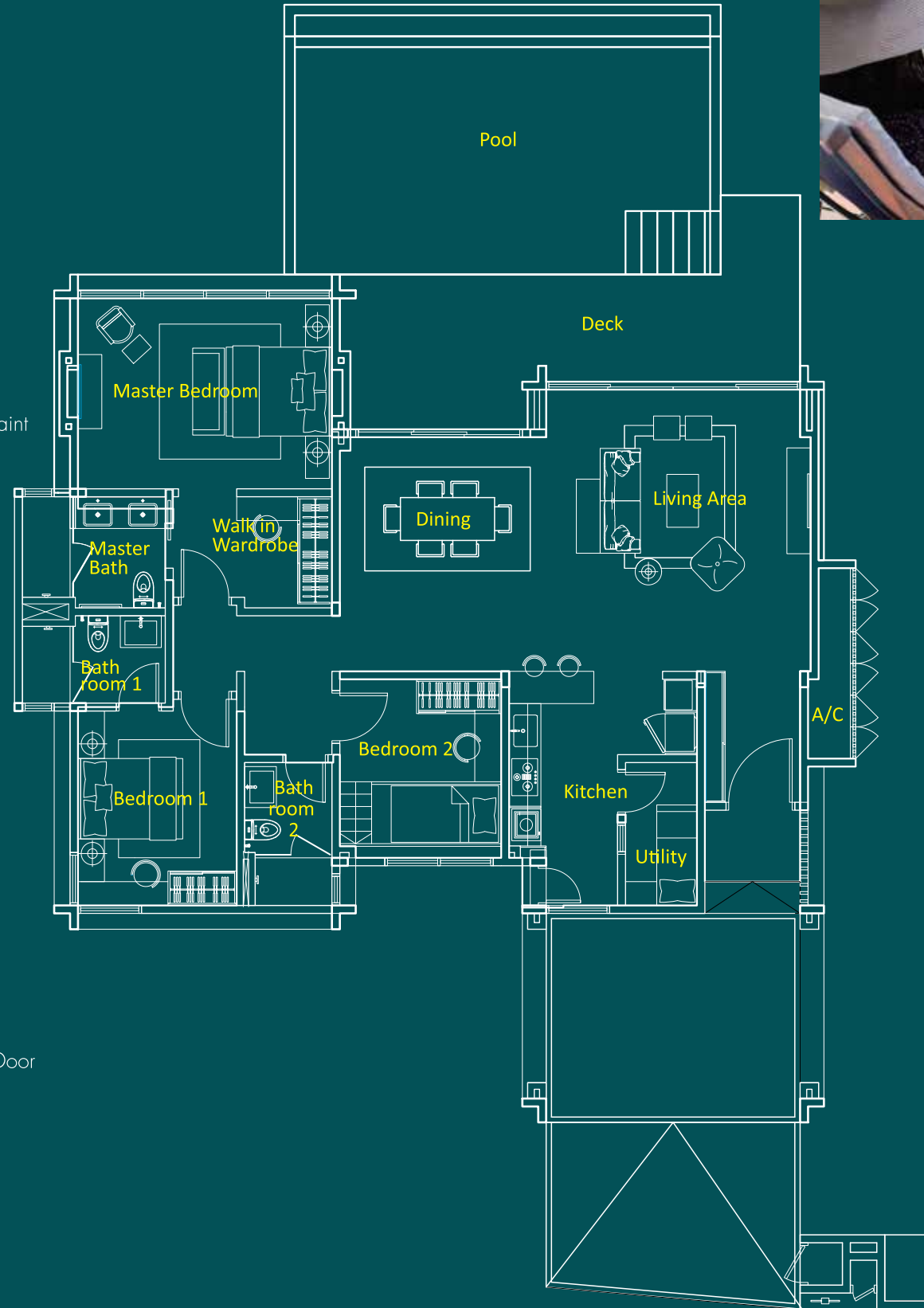

Uninterrupted access to your own private pool and garden will ensure a healthy and clean environment for you and your family.

Eco-friendly considerations are part of the structures and the overall development.





# Borneo

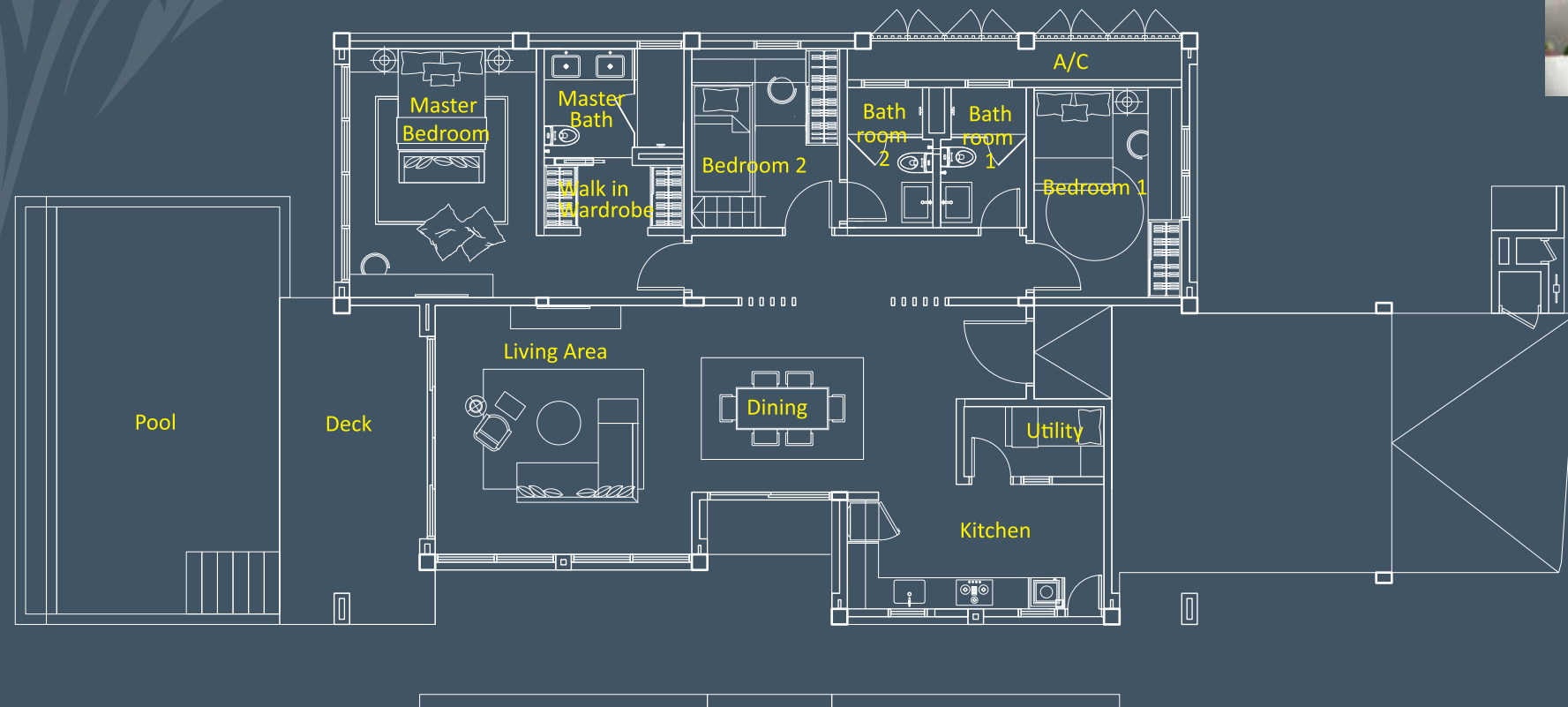

Structure	: Reinforced Concrete	Floor Finishes	: Living / Dining / Kitchen / Terrace / Utility / Master Bathroom / Bathrooms	- Porcelain Tiles
Roof	: Reinforced Concrete Flat Roof / Stone-coated Steel Metal Roof		: Master Bedroom / Other Bedrooms	- Timber Flooring
Wall	: Masonry		: Car Porch / Driveway	- Interlocking Paver
Ceiling Finishes	: Skim Coat / Plaster Ceiling		: Aircon Compressor Area	- Cement Rendering
Wall Finishes	: Internal Paint - Emulsion Paint External Paint - Exterior Weather-resistant Paint Kitchen - Porcelain Tiles Master Bathroom - Porcelain Tiles / Other Bathrooms	Door	: Entrance Bedrooms / Bathrooms / Utility Living / Dining Aircon Compressor Area	- Timber Door - Aluminium Frame Sliding Door - Aluminium Screen Door
	* No finishes will be provided at the back of the fixtures such as mirror, kitchen cabinets and etc (where applicable)	Windows	: Aluminium Frame Window	



The layout was done carefully so as not to cut down the many mature trees on the site and each villa uses eco-friendly LED lighting and comes with solar powered water heating systems.

